



# Meeting of August 6-8, 2015

Westin Arlington Gateway  
801 North Glebe Road  
Arlington, Virginia 22203  
(703) 717-6200

## AGENDA

### Thursday, August 6

8:30 am – 4:00 pm	<b>Closed Session</b> Assessment Development Committee <i>Shannon Garrison, Chair</i> Hemingway 1
4:30 – 6:15 pm	Executive Committee <b>(Closed Session, 5:20-6:15 pm)</b> <i>Terry Mazany, Chair</i> Fitzgerald A

### Friday, August 7

Fitzgerald Ballroom C, D, E

8:30 – 8:50 am	Approval of August 2015 Agenda Approval of May 2015 Board Meeting Minutes Chairman's Remarks <i>Terry Mazany, Chair</i>
8:50 – 9:05 am	Welcome Remarks and Executive Director's Report <i>Bill Bushaw, Executive Director</i>
9:05 – 9:45 am	Trial Urban District Assessments (TUDA): Implications for Education Reform Initiatives <i>Michael Casserly, Executive Director</i> <i>Council of the Great City Schools</i>

## Friday, August 7 (continued)

Fitzgerald Ballroom C, D, E

9:45 – 9:55 am	Institute for Education Sciences (IES) Update <i>Ruth Neild, Deputy Director for Policy and Research, IES</i>		
9:55 – 10:05 am	National Center for Education Statistics (NCES) Update <i>Peggy Carr, Acting NCES Commissioner</i>		
10:05 – 10:15 am	BREAK		
10:15 am – 12:30 pm	<b>Committee Meetings</b>		
	Assessment Development Committee <i>Shannon Garrison, Chair</i> Hemingway 1	Committee on Standards, Design and Methodology <i>Lou Fabrizio, Chair</i> Hemingway 2	Reporting & Dissemination Committee <i>Andrés Alonso, Chair</i> Fitzgerald A
12:45 – 2:45 pm	<b>Closed Working Lunch Session</b> Briefing and Discussion: 2015 NAEP Reading and Mathematics Report Cards <i>Peggy Carr, NCES</i>		
2:45 – 3:15 pm	BREAK		
3:15 – 4:15 pm	Discussion of the Governing Board's Strategic Planning Initiative <i>Breakout Group Leaders:</i> <i>Andrew Ho, Tonya Matthews, Chasidy White</i> Hemingway 1, Hemingway 2, Fitzgerald A		
4:30 – 5:30 pm	Breakout Group Reports and Plenary Discussion <b>ACTION:</b> Strategic Planning Framework <i>Terry Mazany, Moderator</i> <i>Breakout Group Leaders:</i> <i>Andrew Ho, Tonya Matthews, Chasidy White</i>		
5:30 pm	Adjourn		

## Saturday, August 8

7:30– 8:15 am	<p>Nominations Committee (Closed Session) <i>Tonya Miles, Chair</i> Hemingway 2</p>
---------------	-------------------------------------------------------------------------------------------------

### Plenary Session

Fitzgerald Ballroom C, D, E

8:30 – 10:00 am	<p><b>Closed Session</b> Briefing on the Technology and Engineering Literacy (TEL) Assessment and Achievement Levels Setting <i>Lou Fabrizio, COSDAM Chair</i> <i>Cary Sneider, ADC Vice Chair</i> <i>Sharyn Rosenberg, Governing Board Staff</i> <i>William Ward, NCES Staff</i></p>
10:00 – 10:15 am	BREAK
10:15 – 11:15 am	<p><b>ACTION:</b> Assessment Literacy Communications Plan <i>Jim Popham, Work Group Chair</i> <i>Lucille Davy, Work Group Member</i> <i>Tonya Miles, Work Group Member</i> <i>Sharyn Rosenberg, Governing Board Staff</i></p>
11:15 – 11:30 am	<p>Remarks from Outgoing Board Members</p> <ul style="list-style-type: none"> <li>• <i>Andrés Alonso</i></li> <li>• <i>Lou Fabrizio</i></li> <li>• <i>Terry Holliday</i></li> <li>• <i>Sue Pimentel</i></li> </ul>
11:30 am – 12:00 pm	<p><b>Committee Reports and Board Actions</b> <i>Executive Committee</i> <b>ACTION:</b> Election of Board Vice Chair for 2015-2016 <b>ACTION:</b> Resolution on NAEP Funding <i>Assessment Development Committee</i> <i>Committee on Standards, Design and Methodology</i> <i>Reporting and Dissemination Committee</i> <b>ACTION:</b> Release Plan for 2015 Reading and Mathematics Report Cards <i>Nominations Committee</i></p>
12:00 pm	Adjourn

## 2015 - 2016 Quarterly Board Meeting Dates and Locations

MEETING DATES	LOCATION
2015	
November 19 – 21, 2015	Arlington, VA
2016	
March 3 – 5, 2016	Washington, DC
May 12 – 14, 2016	Washington, DC
August 4 – 6, 2016	Chicago, IL
November 17 – 19, 2016	Washington, DC

## The Westin Arlington Gateway

801 North Glebe Road • Arlington, Virginia 22203 • United States  
Phone (703) 717-6200 • Fax (703) 717-6204

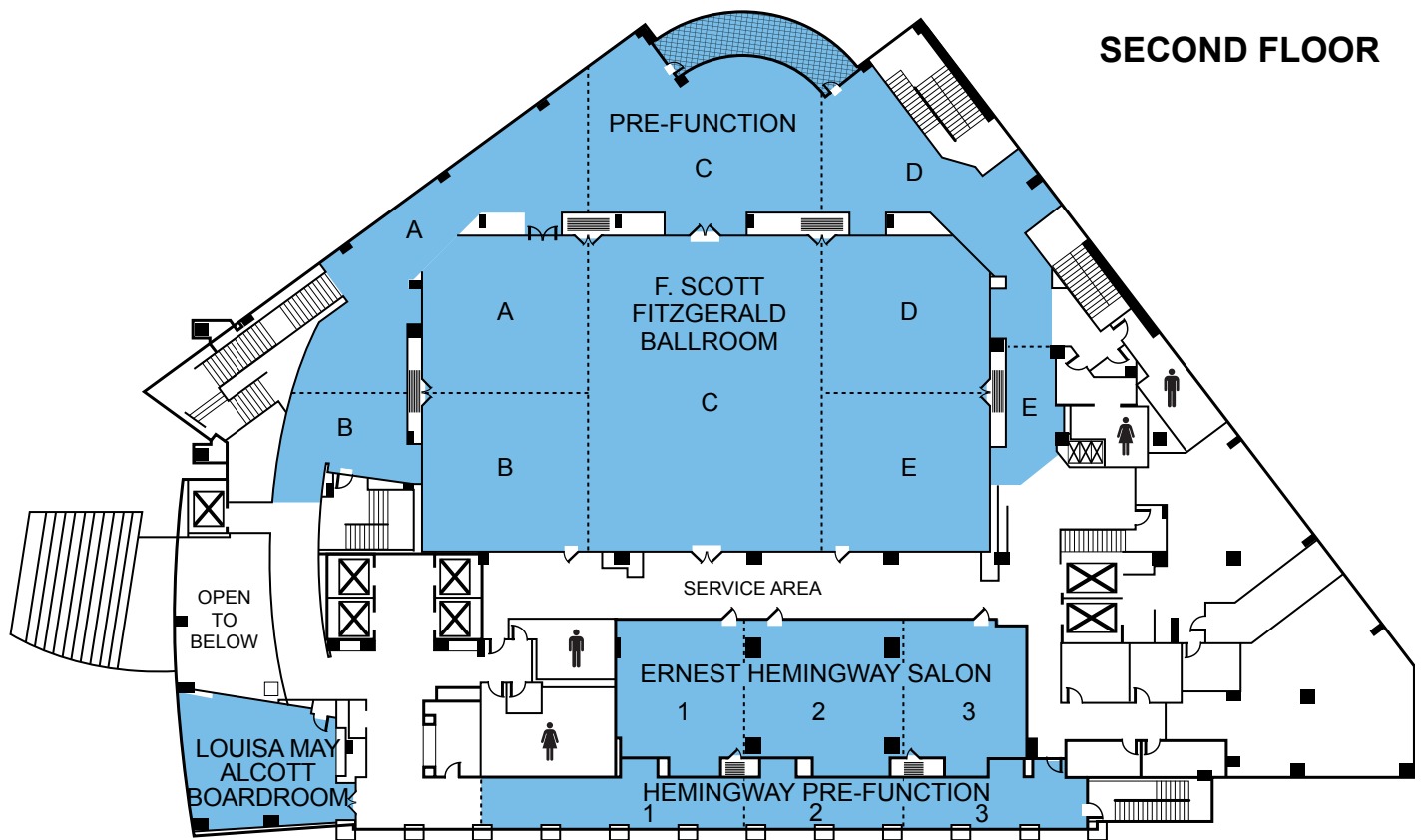

# National Assessment Governing Board

## BOARD MEMBERSHIP (2014-2015)

### **Terry Mazany**

President and CEO  
The Chicago Community Trust  
Chicago, Illinois

### **Susan Pimentel, Vice Chair**

Educational Consultant  
Hanover, New Hampshire

### **Andrés Alonso**

Professor of Practice  
Harvard Graduate School of Education  
Harvard University  
Cambridge, Massachusetts

### **Honorable Mitchell D. Chester**

Commissioner of Elementary and Secondary  
Education  
Massachusetts Department of Elementary  
and Secondary Education  
Malden, Massachusetts

### **Lucille E. Davy**

President and CEO  
Transformative Education Solutions, LLC  
Pennington, New Jersey

### **Louis M. Fabrizio**

Data, Research and Federal Policy Director  
North Carolina Department of Public  
Instruction  
Raleigh, North Carolina

### **Frank K. Fernandes**

Principal, Kaimuki Middle School  
Honolulu, Hawaii

### **Honorable Anitere Flores**

Senator  
Florida State Senate  
Miami, Florida

### **Rebecca Gagnon**

School Board Member  
Minneapolis Public Schools  
Minneapolis, Minnesota

### **Shannon Garrison**

Fourth-Grade Teacher  
Solano Avenue Elementary School  
Los Angeles, California

### **Honorable James E. Geringer**

Former Governor of Wyoming  
Cheyenne, Wyoming

### **Doris R. Hicks**

Principal and Chief Executive Officer  
Dr. Martin Luther King, Jr. Charter School  
for Science and Technology  
New Orleans, Louisiana

**Andrew Dean Ho**  
Associate Professor  
Harvard Graduate School of Education  
Harvard University  
Cambridge, Massachusetts

**Honorable Terry Holliday**  
Commissioner of Education  
Kentucky Department of Education  
Lexington, Kentucky

**Tonya Matthews**  
President and CEO  
Michigan Science Center  
Detroit, Michigan

**Tonya Miles**  
General Public Representative  
Mitchellville, Maryland

**Honorable Ronnie Musgrove**  
Former Governor of Mississippi  
Madison, Mississippi

**Dale Nowlin**  
Twelfth-Grade Teacher  
Columbus North High School  
Columbus, Indiana

**Joseph M. O'Keefe, S.J.**  
Professor  
Lynch School of Education  
Boston College  
Chestnut Hill, Massachusetts

**W. James Popham**  
Professor Emeritus  
University of California, Los Angeles  
Wilsonville, Oregon

**B. Fielding Rolston**  
Chairman  
Tennessee State Board of Education  
Kingsport, Tennessee

**Cary Sneider**  
Associate Research Professor  
Portland State University  
Portland, Oregon

**Chasidy White**  
Eighth-Grade Teacher  
Brookwood Middle School  
Vance, Alabama

Ex-officio Member

**Ruth Curran Neild**  
Deputy Director for Policy and Research  
Institute of Education Sciences (IES)  
Delegated Duties of the Director of IES  
U.S. Department of Education  
Washington, D.C.

# **National Assessment Governing Board**

## **Committee Structure**

### **2014-2015**

#### **Committee on Standards, Design and Methodology**

Chair Lou Fabrizio  
Vice Chair Fielding Rolston  
Mitchell Chester  
Lucille Davy  
James Geringer  
Andrew Ho  
Terry Holliday  
James Popham  
*Sharyn Rosenberg (Staff)*

#### **Reporting and Dissemination Committee**

Chair Andrés Alonso  
Vice Chair Rebecca Gagnon  
Anitere Flores  
Tonya Matthews  
Terry Mazany  
Ronnie Musgrove  
Tonya Miles  
Joseph O'Keefe  
*Stephaan Harris (Staff)*  
*Laura LoGerfo (Staff)*

#### **Assessment Development Committee**

Chair Shannon Garrison  
Vice Chair Cary Sneider  
Doris Hicks  
Frank Fernandes  
Dale Nowlin  
Susan Pimentel  
Chasidy White  
*Mary Crovo (Staff)*

#### **Nominations Committee**

Chair Tonya Miles  
Lucille Davy  
Shannon Garrison  
Doris Hicks  
Andrew Ho  
Joseph O'Keefe  
Susan Pimentel  
Fielding Rolston  
Cary Sneider  
*Mary Crovo (Staff)*

#### **Executive Committee**

Chair Terry Mazany  
Vice Chair Susan Pimentel  
Andrés Alonso  
Lou Fabrizio  
Rebecca Gagnon  
Shannon Garrison  
Tonya Miles  
Fielding Rolston  
Cary Sneider  
*Lily Clark (staff)*